

# Sansibar

## House floor plan

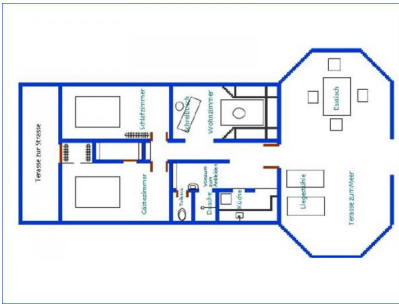

House (140 sqm) incl. large patio directed to the Ocean (45 sqm), bordering the Indian Ocean. Garden with about 1.000 sqm with trees, flowers, sand ways, pending swing and open pavillon with lounge directly at the Indian Ocean

- . Windows are provided with metall bars, mosquito nets and very nice parted wooden shutters
- . running water in the house
- . electricity 220 + 230 Volt
- . floors with white flags or cement
- . walls made of coral stone, chalked white
- . traditional Makuti-roof made of palm leaves
- . garden about 1.000 sqm with trees, flowers, sand ways, pending swing and open pavillon (about 15 sqm) with loungers directly at the Indian Ocean
- . open kitchen 6 sqm, living room 21 sqm, patio 45 sqm, two sleeping rooms 20 sqm and 23 sqm, shower and bathroom 10 sqm, corridor 18 sqm



Entrance Kitchen



Writing Place in the Livingroom



Living Room



Guest Room



Sleeping Room

Ferienhaus auf Sansibar | 06209/1070 | [www.sansibar.biz](http://www.sansibar.biz)